

# Mehrstrahldüsen

## Multiple Spray Nozzles

**MS**  
1" + 2"

### Anwendungen

- Brandschutz
- Brandbekämpfung
- Kühlen von Luft, Gas und Feststoffen

### Applications

- Fire Protection
- Fire Fighting
- Air, Gas and Parts Cooling

Mehrere ineinandersprühende Hohlkreise bilden ein Vollkreisspritzbild mit feinen Tropfen.

Multiple hollow cone sprays form a full cone spray pattern with small droplets.

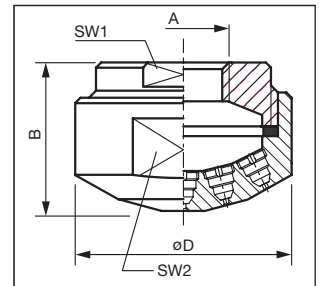
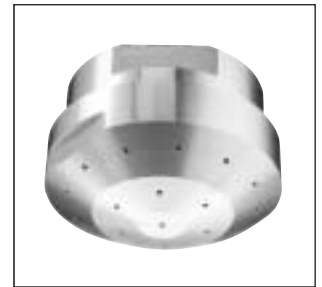
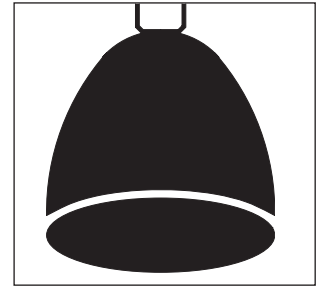

## Volumenstromtabelle / Capacity MS-1"

Düsen- typ Nozzle Type	Durchfluss l/min Capacity l/min						Spritzwinkel bei 2 bar / Spray Angle at 2 bar 130°	
	0,5 bar	1,0 bar	2,0 bar	3,0 bar	5,0 bar	10,0 bar	d ø (mm)	e (mm)
MS-56	17,7	25,0	35,4	43,4	56,0	79,2	4,0	2,5
MS-63	19,9	28,2	39,8	48,8	63,0	89,1	4,5	2,5
MS-90	28,5	40,3	56,9	69,7	90,0	127,9	3,5	2,5
MS-125	39,5	55,9	79,1	96,8	125,0	176,8	5,5	2,5
MS-180	57,0	81,0	114,0	139,0	180,0	255,0	6,0	2,5

d = Austrittsbohrung / Orifice Diameter

e = Engster Querschnitt / Max. Free Passage

**Material:** Ms 1.4571 **Gewinde:** G 1"  
**Material:** Brass SS316 **Thread:** 1" BSPP

**Bestell-Beispiel:** Düsentyp - Spritzwinkel - Gewinde - Material  
**Ordering Information:** Nozzle Type - Spray Angle - Thread - Material

MS-4 - 70° - G 1/2 - 1.4571

Abmessungen (mm) < 130° Dimensions (mm) < 130°						Gewicht Weight
A	D	B	SW1	SW2		kg
1"	120	82	90	110		4,5
2"	155	102	120	140		10,0

## Volumenstromtabelle / Capacity MS-2"

Düsen- typ Nozzle Type	Durchfluss l/min Capacity l/min						Spritzwinkel bei 2 bar / Spray Angle at 2 bar 130°	
	0,5 bar	1,0 bar	2,0 bar	3,0 bar	5,0 bar	10,0 bar	d ø (mm)	e (mm)
MS-180	57,0	81,0	114,0	139,0	180,0	255,0	8,0	4,5
MS-240	76,0	107,0	151,0	185,0	240,0	338,0	9,0	4,5
MS-320	101,0	143,0	202,0	248,0	320,0	452,0	9,0	4,5
MS-350	111,0	157,0	222,0	272,0	350,0	496,0	10,0	4,5
MS-480	152,0	215,0	304,0	372,0	480,0	680,0	10,0	4,5
MS-630	199,0	282,0	399,0	488,0	630,0	892,0	11,0	4,5
MS-800	253,0	358,0	506,0	620,0	800,0	1.132,0	12,0	4,5

d = Austrittsbohrung / Orifice Diameter

e = Engster Querschnitt / Max. Free Passage

**Material:** Ms 1.4571 **Gewinde:** G 2"  
**Material:** Brass SS316 **Thread:** 2" BSPP

**Bestell-Beispiel:** Düsentyp - Spritzwinkel - Gewinde - Material  
**Ordering Information:** Nozzle Type - Spray Angle - Thread - Material

MS-320 - 130° - G 2 - 1.4571

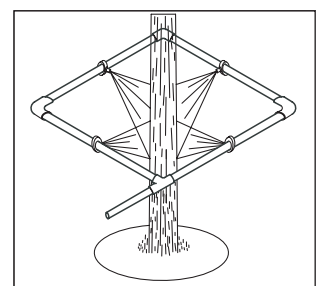
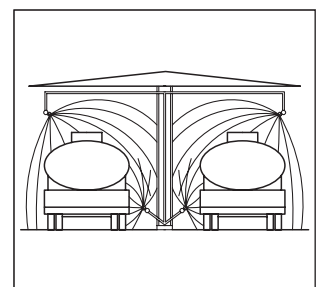

Zubehör Seiten 8.01 - 8.10 / Accessories pages 8.01 - 8.10